

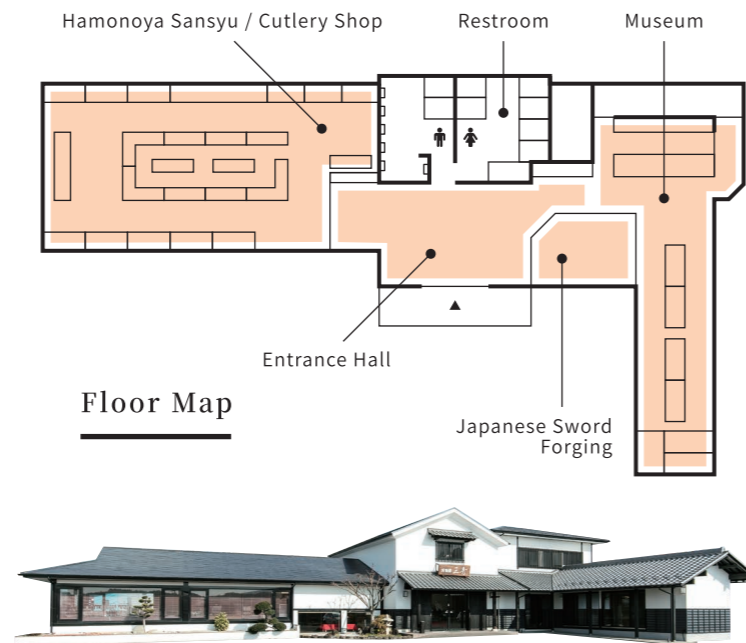

Seki-city, Gifu prefecture, Japan
“The origin of masterpiece”
The greatest craftsman skill
has been inherited even today ...

History of “Seki no Hamono” dates back to the time when swordsmith moved in Seki and started making swords in Muromachi period. “Never break, never bend, cut well” the reputation of Seki swords spread in all over Japan. Seki has been supporting the Japanese swords industry for over 700 years. Cutting tool industry in Seki city started from swordsmith. Today, its products made with tradition and modern technology range from kitchen knife to scissors, razor, nail clipper and many items. Seki brand is now highly evaluated from many directions as a cutting tool producing area exporting to the world.



1938
刃物屋
 cutler SANSYU
三秀®
 950-1, Oze, Seki City, Gifu, 501-3265 Japan
 ☎ 9:00~16:30 7 days a week
 ☎ +81-575-28-5147 📠 +81-575-28-5878



Web 🌐 www.hamonoyasan.com



EC 🌐 sansyu.myshopify.com



Map 📍 Google



関刃物ミュージアム
 SEKI HAMONO MUSEUM

ENGLISH

1938
刃物屋
 cutler SANSYU
三秀®



MADE IN SEKI
JAPAN

World-renowned cutlery of SEKI

Seki-city of Japan is highly regarded as “the world’s third largest cutlery producing area” along with Solingen in Germany and Sheffield in England. Its skill and quality supported by history and tradition are appreciated not only in Japan but also overseas. Seki-city, which has grown to become a world brand, has three important conditions for producing of cutlery. The first one is an abundant water source of the Nagara river. The second one is the coal for quenching. And the third is the red clay painted when making a blade. Even today as the industry has been modernized, the rich natural environment of water, mountains and soil supports the cutting tool industry.



Hamonoya Sansyu / Cutlery Shop Admission free

For professional to kitchen knives, we have a wide range of kitchen knives, scissors, nail clippers, etc. which are sold directly by manufactures in Seki City.

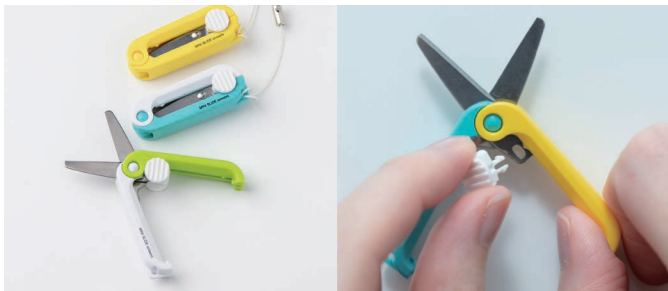

Mini-scissors assembly experience Pay trial

You can experience assembling mini scissors that are convenient for carrying things. Of course you can take the finished product home on that day. (Time required 20 minutes) **[Reservation required]**



Samurai show (irregular holding)



Japanese sword forging by the 25th and 26th generations of Fujiwara Kanefusa.

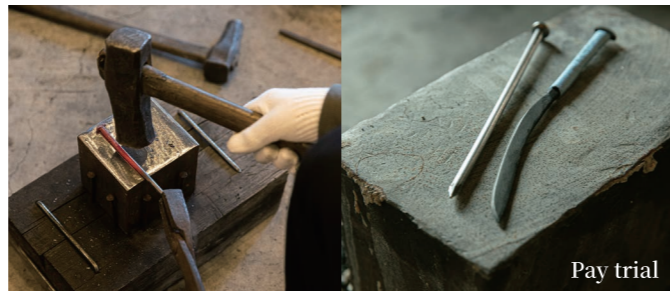

Experience making paper knives from five-inch nails. Pay trial

The original paper knife is made by processing 5 inch nails directly from Fujiwara Kanefusa Sword smith. You can take the finished product home on that day. (Time required 120 minutes) **[Reservation required]**



Casual kimono experience (irregular holding)



Cutlery Museum Admission free

The Seki Cutlery Museum is an experiential complex facility run by the Cutlery Shop Sansyu. It is a museum where it can not only sell things but also spread the background of things and people, and see, feel, and enjoy the charm of Japan, Gifu Prefecture, and Seki City. *You can't enter at that time of fending.

Advance reservation system (Visits and reservations)

- *Please make a reservation for each tour and experience at least one month in advance.
- *Depending on the date, we may not be able to handle it.
- *Depending on the tour experience, there is a limit on the number of people and age.
- *Please contact us for each fee.



Tours and experiences of Sword smith Pay trial

Experience the craftsmanship of Sword smith up close. You can also actually experience hitting steel. **[Reservation required]** Only part of the manufacturing process can be observed.

